

HOW TO LOG IN

EZBZ ID

Enter your company's unique EZBZ ID in CAPITAL LETTERS

username

enter username (email) in lower case letters

Password

Enter Password

SIGN IN

click SIGN IN button
And you're in!

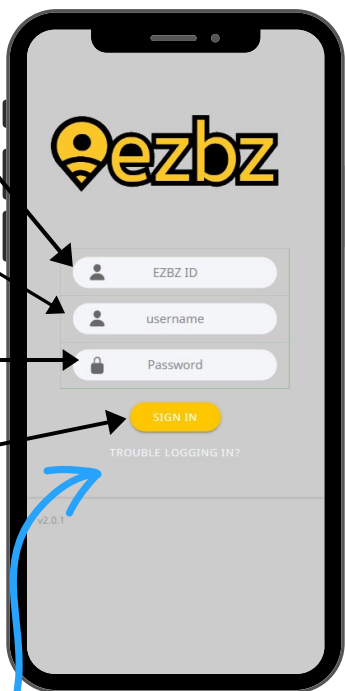

Forgot Password?

Click the 'TROUBLE LOGGING IN?' link

Provide the company's EZBZ ID and the email address used for your username, then check your email! Don't forget to check your spam folder if you don't see the Password email!

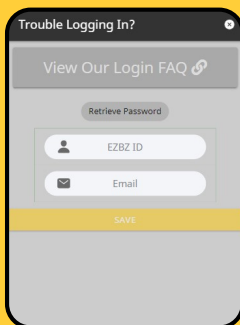

Still can't log in?

- Check with your company's admin to make sure you are using the correct EZBZ ID, username, and password
- Make sure there are no spaces at the end of the EZBZ ID, username, or password. This happens a lot with autofill!
- You can find more guidance here: ezbz.app/trouble-logging-in/
- Contact us. We're happy to help: ezbz.app/support or support@ezbz.app